

HM9C



- Nickel plated alloy steel IP68 dual shear beam load cell
- High accuracy
- Suitable for truck and track scales and other heavy weighing devices
- Hermetically sealed

Available models

Capacity	Accuracy	Full article description
10 Klb	C3	HM9C-C3-10K-9B
20 Klb	C3	HM9C-C3-20K-9B
30 Klb	C3	HM9C-C3-30K-9B
40 Klb	C3	HM9C-C3-40K-9B
50 Klb	C3	HM9C-C3-50K-9B
60 Klb	C3	HM9C-C3-60K-9B
75 Klb	C3	HM9C-C3-75K-9B

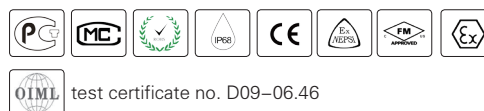

Specification

Accuracy class		OIML R60 C3
Output sensitivity (= FS)	mV/V	3.0 ± 0.008
Maximum capacity (E _{max})	klb	10, 20, 30, 40, 50, 60, 75
Maximum number of load cell intervals (nLC)		3000
Ratio of minimum LC verification interval Y = E _{max} / V _{min}		10000
Combined error	%FS	± 0.023
Minimum dead load	klb	0
Safe overload	of E _{max}	150 %
Ultimate overload	of E _{max}	300 %
Zero balance	%FS	± 1.0
Excitation, recommended voltage	V	5 ~ 12(DC)
Excitation maximum	V	18(DC)
Input resistance	Ω	700 ± 7
Output resistance	Ω	700 ± 7
Insulation resistance	MΩ	≥ 5000 (50VDC)
Compensated temperature	°C	-10 ~ +40
Operating temperature	°C	-35 ~ +65
Storage temperature	°C	-40 ~ +70
Element material		Alloy steel
Ingress protection (according to EN 60529)		IP68
ATEX classification (optional)		II1G Ex ia IIC T4 II1D Ex iaD 20 T73°C C II3G Ex nL IIC T4

Dimensions in mm

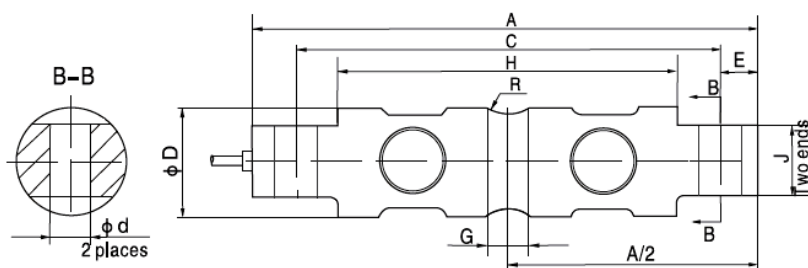

Dimension	A	C	H	G	ΦD	J	Φd	R	E
Capacity (klb)									
10	206.2 (8.12)	174.6 (6.88)	133.1 (5.24)	15.7 (0.62)	Φ43.2 (1.7)	28.4 (1.12)	Φ16.7 (0.66)	R12.7 (0.5)	15.7 (0.62)
20	206.2 (8.12)	174.6 (6.88)	133.1 (5.24)	21.3 (0.84)	Φ49.5 (1.95)	28.4 (1.12)	Φ16.7 (0.66)	R12.7 (0.5)	15.7 (0.62)
30-75	260.0 (10.24)	215.9 (8.5)	165.1 (6.5)	25.4 (1.0)	Φ76.2 (3.0)	60.2 (2.37)	Φ26.9 (1.06)	R25.4 (1.0)	22.2 (0.87)

Wiring

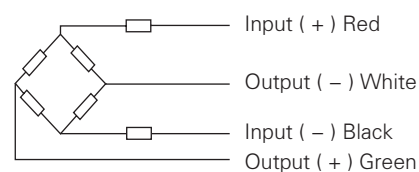

- Shielded, 4 conductor cable.
- Φ5mm(5k-20klb) Φ8mm(30k-250klb).
- Standard cable length: 9m
- Cable type and length for customer's own application are available on request.